



Prepared By
Greene County
 Real Property Tax Service
 411 Main Street
 Catskill, NY 12414
 (518) 719-3525

THIS MAP WAS PREPARED FOR TAX ADMINISTRATION PURPOSES ONLY.
 NOT INTENDED FOR USE IN CONVEYANCE OF LAND. ABSOLUTE NO ACCURACY
 OR COMPLETENESS GUARANTEE IS IMPLIED OR INTENDED. ALL INFORMATION
 ON THIS MAP IS SUBJECT TO SUCH VARIATIONS AND CORRECTIONS
 AS MIGHT RESULT FROM A COMPLETE TITLE SEARCH AND/OR
 ACCURATE FIELD SURVEY.

MAP CONVERTED TO ANTI-CIPSO FORMAT
 BY ANALYTICAL SURVEYS, INC. NOVEMBER 1998

DIGITALLY CONVERTED SUMMER 2006
 BY WEILER MAPPING, INC. A DIVISION OF THE JAMES W. BEWELL CO.
 NAD 1983 STATE PLANE, NEW YORK EAST FEET

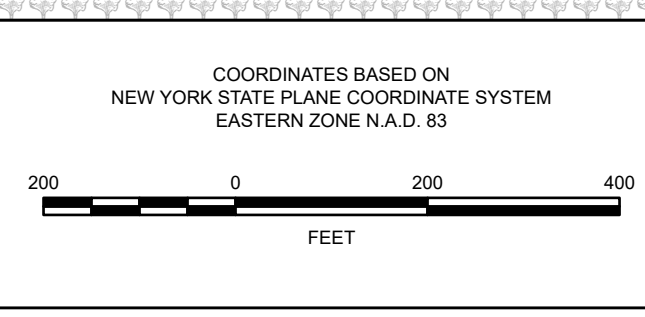

MAP DATES	
PUBLICATION DATE:	3/1/2008
REVISION DATE:	7/13/2009
CONVERSION TO NAD 1983:	1/22/2006
N.Y.S. CONVERSION APPROVAL:	4/14/2004
CONVERSION TO DIGITAL FORMAT:	1998 & 2003
N.Y.S. APPROVAL:	12/21/1981

SPECIAL DISTRICTS	
SCHOOL:	15901
FIRE:	LEXINGTON
WATER:	
LIGHT:	
HYDRANT:	
SEWER:	

LEGENDS	
PROPERTY LINE	---
BLOCK LIMIT LINE	---
TOWN VILLAGE CITY	---
COUNTY LINE	---
GREAT LOT OR TRACT LINE	---
SCHOOL DISTRICT LINE	---
FIRE DISTRICT LINE	---
WATER DISTRICT LINE	---
SEWER DISTRICT LINE	---
LIGHT DISTRICT LINE	---
RAILROAD	---

LEGENDS	
GREAT LOT OR TRACT NUMBER	①
TAX MAP BLOCK NUMBER	②
SUBDIVISION LOT NUMBER	(14)
TAX MAP LOT NUMBER	21
SUBDIVISION LOT LINE	---
WATER COURSE	---

CALCULATED ACREAGE	
DEED ACREAGE	17.5A(3)
SCALED DIMENSION	225'
DEED DIMENSION	173'
COORDINATE LOCATOR POSITION	
DENOTES COMMON OWNER	

127.00	127.00
127.00	127.04

SHEET INDEX

TAX MAP
TOWN OF LEXINGTON
GREENE COUNTY
NEW YORK

127.02